



READ FIRST

HIGH POWER TOUCH SCREEN WI-FI RANGE EXTENDER TAP-EX

Getting to Know the Range Extender

- 1 LCD Screen: 3.5" LCD touch screen. Displays the user interface for configuring the Range Extender.
- 2 Stylus: Input tool that assists in navigating the LCD touch screen menu.
- 3 Antenna Connector: RJ-SMA antenna connector. Compatible with all antennas that have RP-SMA connectors.
- 4 Reset: Button used to reset device. Push down once to reboot, hold down for 5-10 seconds to reset to factory default settings.
- 5 USB Port: USB 2.0 Port used to attach USB storage devices, such as a USB flash drive or external hard drive, for file sharing.
- 6 Wired Ports: RJ-45 ports for connecting wired computers or network devices.
- 7 Power (PWR): Power adapter port. DC 12V 1A.



Setting Up Your Range Extender

1 Find an Optimal Setup Location Between your Wireless Router and your Wireless Dead Zone

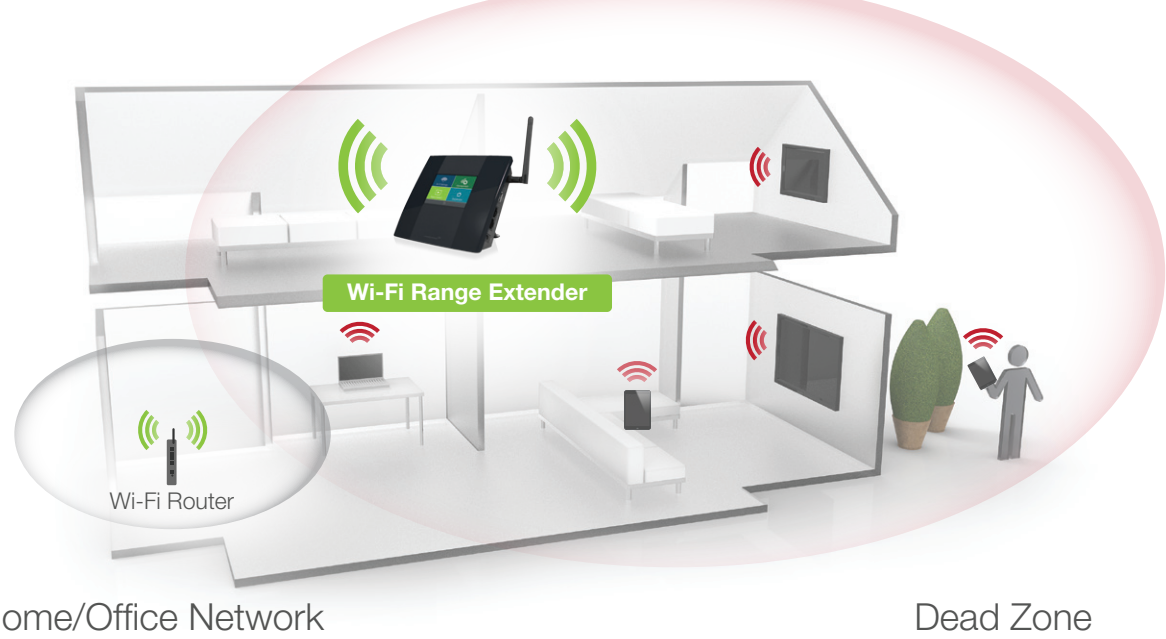

IMPORTANT: PLACE THE **RANGE EXTENDER** IN A LOCATION WHERE IT CAN RECEIVE A STRONG SIGNAL FROM YOUR WIRELESS ROUTER.

RECOMMENDED SIGNAL STRENGTH: **>70%**

This can be done before or after setup is complete. The Range Extender will save your settings.

2 Power on the Range Extender

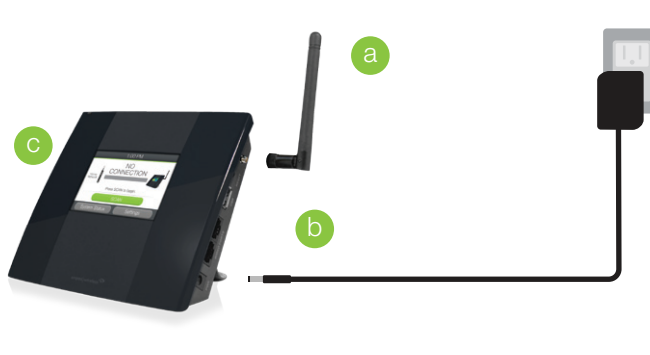

- a Attach the included antenna.
- b Attach the Power Adapter to the Range Extender's power port and an available power outlet.
- c The Amped Wireless logo will appear as the unit boots up, then the Dashboard screen will appear.

3 Welcome to the Dashboard

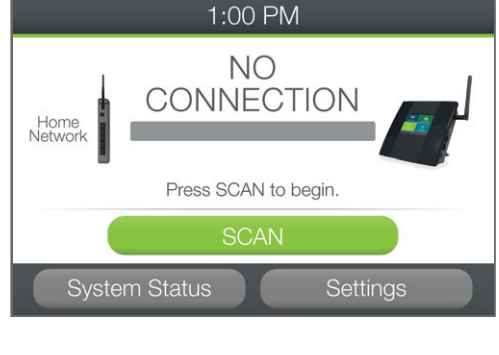

The Dashboard will provide you with the current status of the Range Extender.

Tap **Scan** to find available networks to extend.

Note: The Setup Guide will refer to the existing network that you wish to extend as the **Home Network**. The new, expanded network will be referred to as your **Extended Network**.

4 Scan for a Home Network to Extend

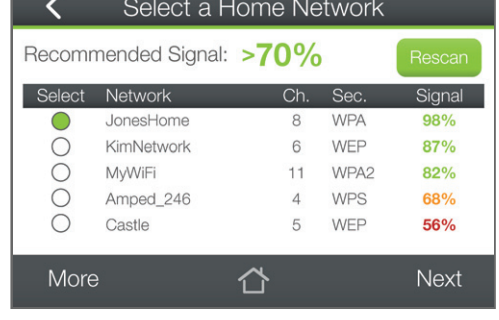

Select the Wi-Fi network that you wish to extend.

>70% Recommended Signal

Select the Wi-Fi network with a signal strength greater than **70%** for the most reliable connection.

Poor signal connections may cause slow speeds or dropped connections.

Tap **Next** to continue.

If you do not see your desired wireless network, move the Range Extender closer to the router and scan again as it may be out of range.

5 Home Network Security Settings (if necessary)

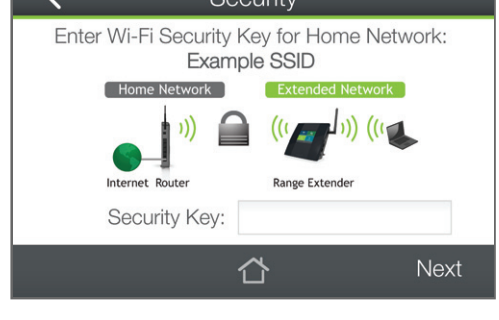

If your Home Network has security enabled, you will need to enter the key here.

Tap **Next** to continue.

6 Configure Settings for your Extended Network

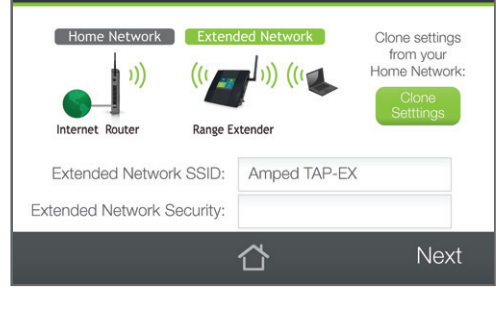

The default ID of your Extended Network is: **Amped TAP-EX**

If you choose to **Clone Settings** from your Home Network, the wizard will copy the SSID and Security Key of your Home Network. The SSID of the Extended Network will have a "_RE" at the end of its name. For example: Home_Network_RE

You can also manually enter a new Network ID and Security Key. The new Security Key must be at least 8 characters long.

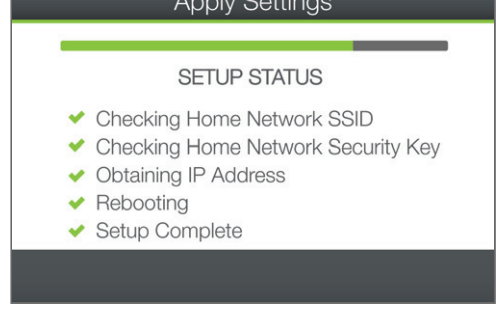

Tap **Next** to apply the settings.

The Setup Wizard will apply your settings. Please be patient. If there are any problems with the connection a prompt will appear letting you know what to fix.

7 Setup Summary

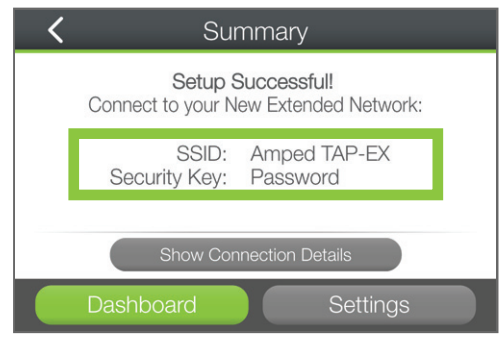

At this point you can connect your Wi-Fi devices to your Extended Network using the Wi-Fi network name and password on the screen.

If you haven't already positioned your Range Extender in an optimal location, you may do so now. All Range Extender powered off for relocation.

You may also attach any wired network devices to the wired ports on the side of the Range Extender.



If you experience any problems during this process, please contact Amped Wireless Elite Support:

Phone: 888-573-8820 or 909-217-3168
Email: techsupport@ampedwireless.com
Web: www.ampedwireless.com/support

Navigating the Touch Menu

- Home Button: Tap the **Home** icon, found on the bottom of many screens, to return to the Dashboard at any time.
- Language Selection: Tap the **Globe** icon, found on the bottom of the Settings screen, to change the language of the menu.
- Back Arrow: Tap the **Left Arrow**, found on the upper left corner of many screens, to navigate back to the previous page.
- Navigation: Tap the **Left** or **Right Arrow** to navigate between multiple pages for one screen. The dots in this example indicate there are 3 pages to see.
- Keyboards/Keypads: Tap on a **Blank Field** to access a keyboard or keypad for entering information such as your Network ID and Security Key.

How to Connect to the Range Extender

Windows 7 & Vista

Click on the Wireless icon to see available wireless networks (For Vista, click Start > Connect To). Select the **Amped TAP-EX** network and click Connect.

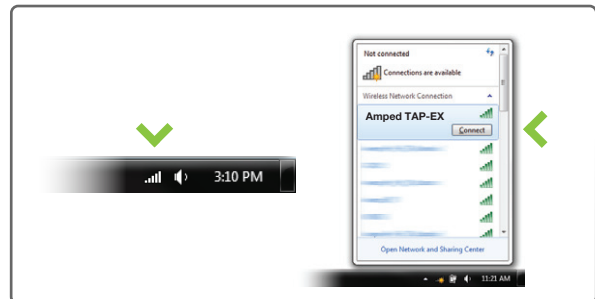

Windows 8

Swipe in from the right edge to access the charms bar, tap on Settings, select the Wi-Fi icon, and select the **Amped TAP-EX** network.

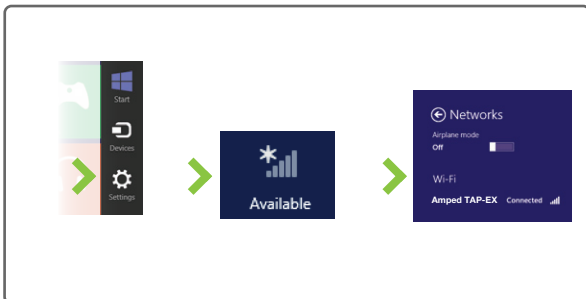

Mac OS X

Click on the Wireless icon to see available wireless networks. Select the **Amped TAP-EX** network.

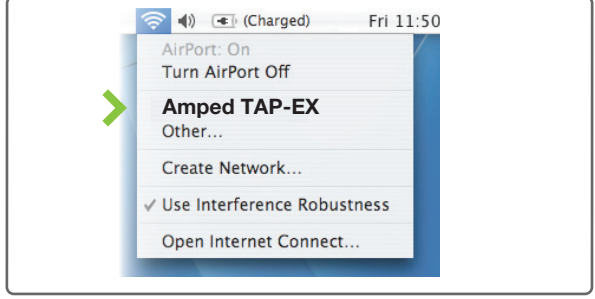

iPhone

Tap on your Settings icon, select Wi-Fi, and choose the **Amped TAP-EX** network.



iPad Tablet

- Press the **Home** button to get to the homepage.
- Tap the **Settings** app icon.
- Tap on **Wi-Fi** to enter the iPad's Wi-Fi settings.
- Toggle the Wi-Fi On/Off selector switch to **On**.
- Under "Choose a Network...", select: **Amped TAP-EX**.

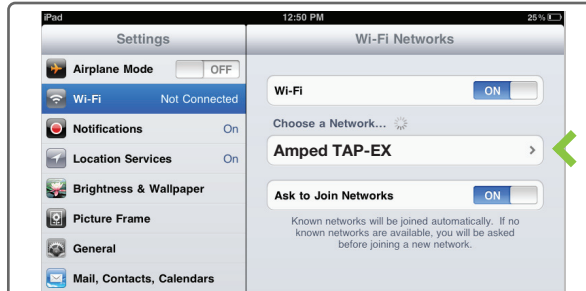

Android Tablet

- Tap the **Apps** menu on the tablet screen.
- Locate and tap the **Settings** app icon.
- Under "Wireless & networks," tap **Wi-Fi settings**.
- Tap the **Wi-Fi box** to turn on Wi-Fi and scan.
- Under "Wi-Fi networks", select: **Amped TAP-EX**.

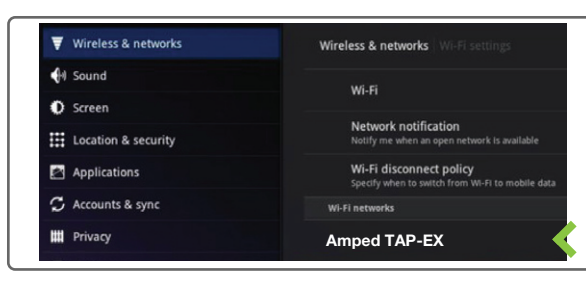

Accessing More Settings

Wi-Fi Settings



The Settings menu can be accessed from the Dashboard. Tap **Settings**.

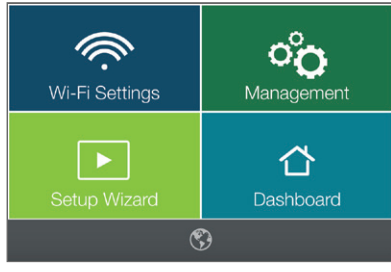

From the Settings menu, tap **Wi-Fi Settings** to access additional Wi-Fi features.

> The Wi-Fi Settings menu allows you to access a number of settings:



Set up a **Guest Network** with an ID and Security Key that's different from your primary extended network.

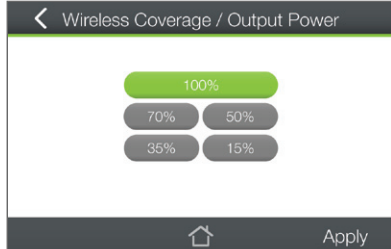

Adjust the distance (output power) of your Wi-Fi network using **Wireless Coverage** settings.

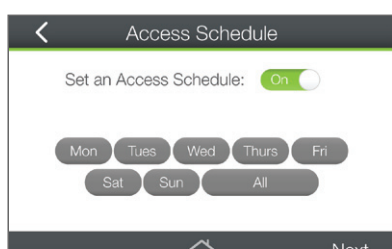

Control when your Extended Network is on or off with **Access Schedule**.

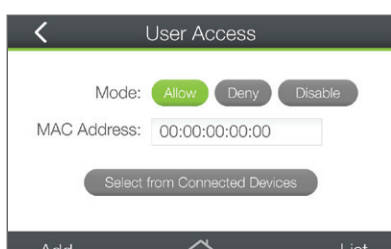

Restrict or allow network access to specific users via their MAC address with **User Access**.

Not all features listed. Access the menu for all settings.

Management Settings

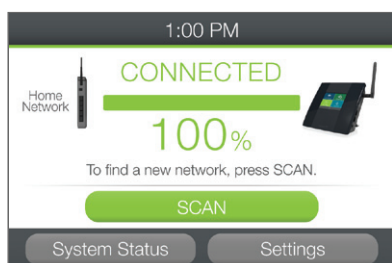

The Settings menu can be accessed from the Dashboard. Tap **Settings**.

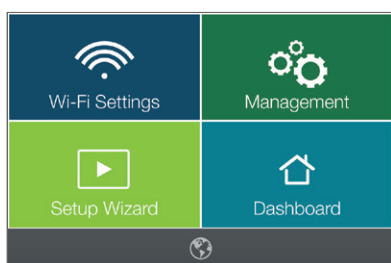

From the Settings menu, tap **Management** to access additional device management features.

> The Management menu allows you to access a number of settings:

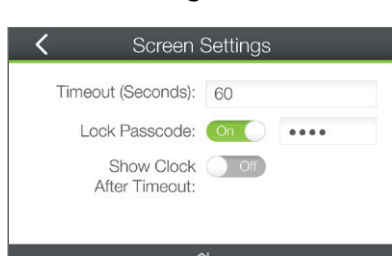

Set the timeout interval for the screen to turn off and set a passcode to re-access the screen using **Screen Settings**.

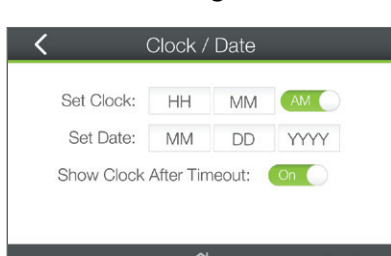

Set the time and date from the **Clock/Date** settings. Set the clock to appear on the screen after the Extender times out.



Check for the latest software updates using the **Firmware Update** feature.

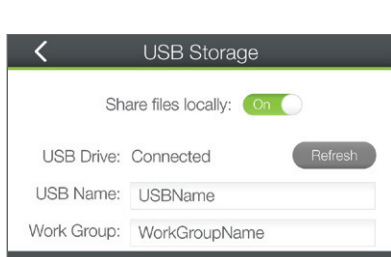

Share files locally from any USB storage device from the **USB Storage Sharing** menu.

Not all features listed. Access the menu for all settings.

More Detailed Settings are Available on the Web Menu

Connect your Internet Device to the Range Extender



Open your Web Browser & Access the Setup Menu

Enter the setup web address into your browser:

<http://setup.ampedwireless.com>

If the URL fails to open, then try: <http://192.168.1.240>

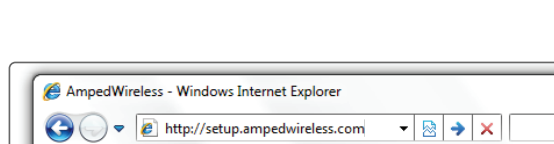

Recommended browsers: Google Chrome, Safari or Internet Explorer (8.0 and up). Do not use Firefox.

ACCESSING THE WEB MENU DOES NOT REQUIRE INTERNET ACCESS. THE MENU IS SERVED FROM THE RANGE EXTENDER.

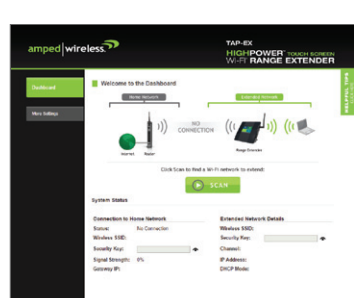

The web menu **Dashboard** will provide you with the current status of the Range Extender. The **More Settings** tab on the left will give you access to more extensive settings.

IF YOU HAVE PROBLEMS ACCESSING THE WEB MENU...

- Disconnect your PC from all Wi-Fi networks.
- Attach an Ethernet cable (not included) between the PC and the Range Extender.
- Open your web browser and go to <http://setup.ampedwireless.com> again.



How to Reset the Range Extender to Default Settings

There are two options to reset the Range Extender back to factory default settings:

- Access the physical Reset button on the right panel of the Range Extender. Hold down the Reset button for five to ten (5-10) seconds. You may need to use a pen tip or pin to access the button. Pressing the Reset Button for less than five (5) seconds will simply reboot the Range Extender while saving your existing settings.
- Access the Reset button through the web menu on the left side under **More Settings > Management > Save/Reload Settings**. Select **Reset Settings to Default**.



If you continue to have issues setting up the Range Extender, give us a call — we're here to help: 888-573-8820 or 909-217-3168. Visit our website for more support information and answers to frequently asked questions: www.ampedwireless.com/support