



— READ FIRST —

High Power Wireless-300N Smart Access Point

AP300

1 Connect the Smart Access Point to your Router

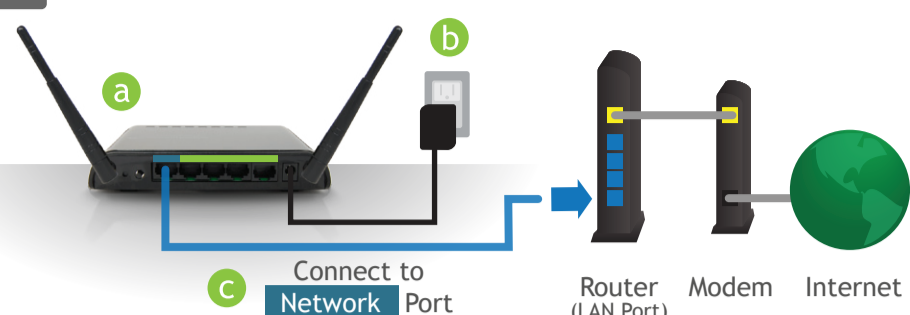

- a Attach the Antennas
 - b Plug in the Power Adapter
 - c Connect the Smart Access Point to your Router's **Network (LAN)** port, or a network switch.
- ✓ Allow up to two (2) minutes for the Smart Access Point to automatically configure itself to your network

2 Connect your Computer to the Smart Access Point

Wireless Connections:

Scan for available wireless networks on your PC and connect to the following network:



NETWORK ID:	Amped_AP
PASSWORD:	wireless

Wired Connections:

Attach any **Wired Devices** to the Smart Access Point using an Ethernet cable.



Congratulations, you're done!



The instructions below are optional. You may now use your Smart Access Point without any additional configurations. However, if you wish to change any settings (such as network ID and security) for the Smart Access Point, follow the instructions below to access the configuration menu of the Access Point.

Note: If your network uses static IP address assignments, you will need to manually configure the settings for your Smart Access Point. See the instructions on the back to access the configuration menu of the Access Point.

1 Optional Configurations: Accessing the Settings Menu

Scan for available wireless networks on your PC and connect to the following network:

NETWORK ID:	Amped_AP
PASSWORD:	wireless

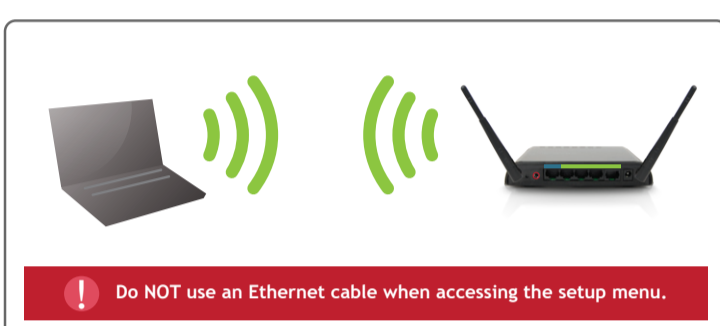
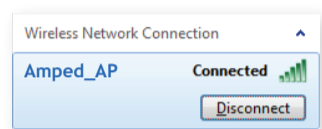

2 Open your Web Browser

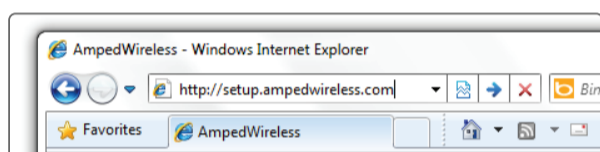

Enter the setup web address into your browser:

<http://setup.ampedwireless.com>

If the URL fails to open, then try: <http://192.168.1.240>

3 Welcome to the Smart Setup Wizard



The wizard will guide you through the setup of your:

- 1 System Clock
- 2 Wireless Network SSID
- 3 Wireless Network Security Key

Click **Start** to begin.

4 Set the System Clock Time

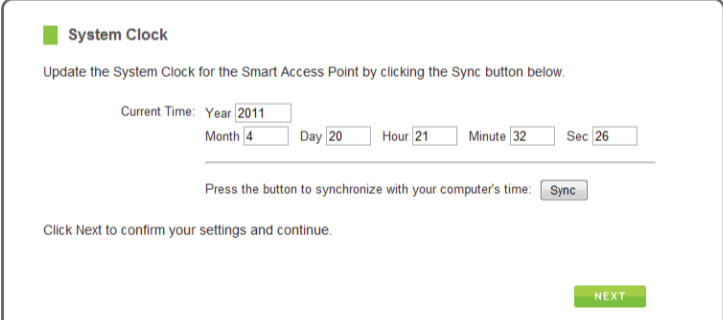

The System Clock is used for system logs and setting schedules for Internet access. Click **Sync** to synchronize the System Clock with the time on your computer.

Click **Next** to continue.

5 Wireless Network ID

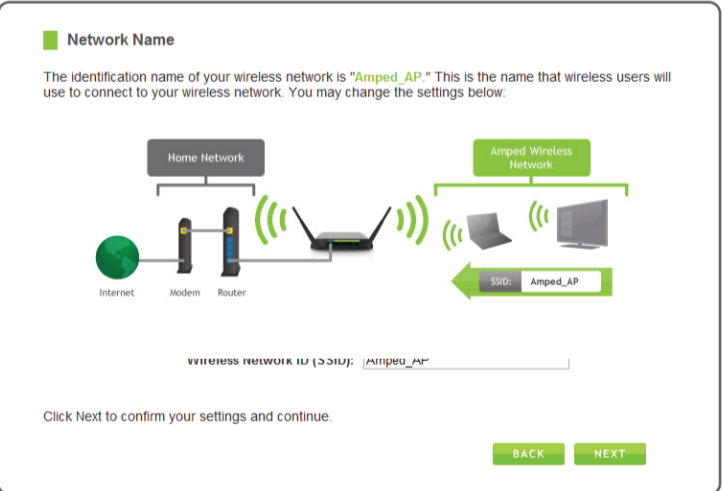

The ID of your Wireless Network is: **Amped_AP**

To change it, enter a new name in the SSID field. Users connecting wirelessly to the Access Point will use this ID to identify your wireless network.

Click **Next** to continue.

6 Wireless Network Security

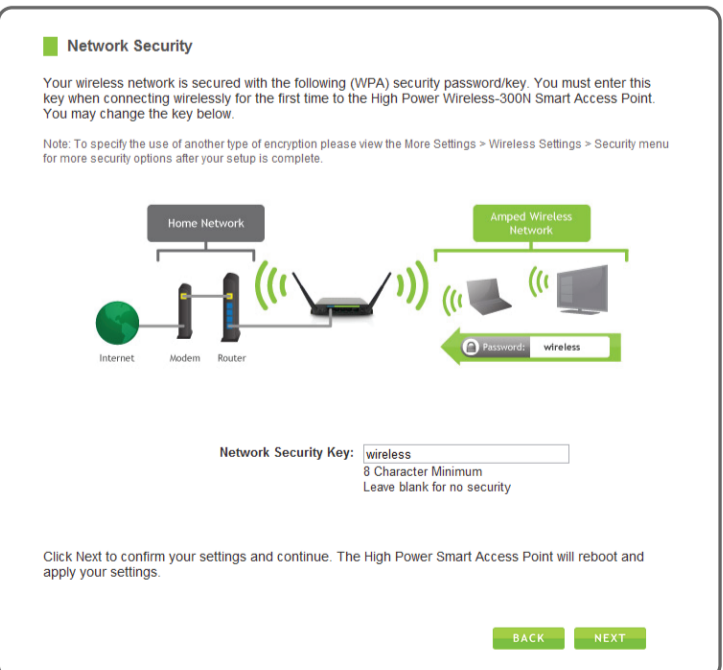

The default Security Key (WPA) of your wireless network is: **wireless**

To change it, enter a new key in the Security Key field. The key must be at least 8 characters long.

Click **Next** to apply your settings.

The Smart Access Point will reboot. This process may take up to 2 minutes. The page will automatically reload after the countdown. If it does not, you may need to reconnect to the Access Point and refresh the page manually.

7 Setup Summary

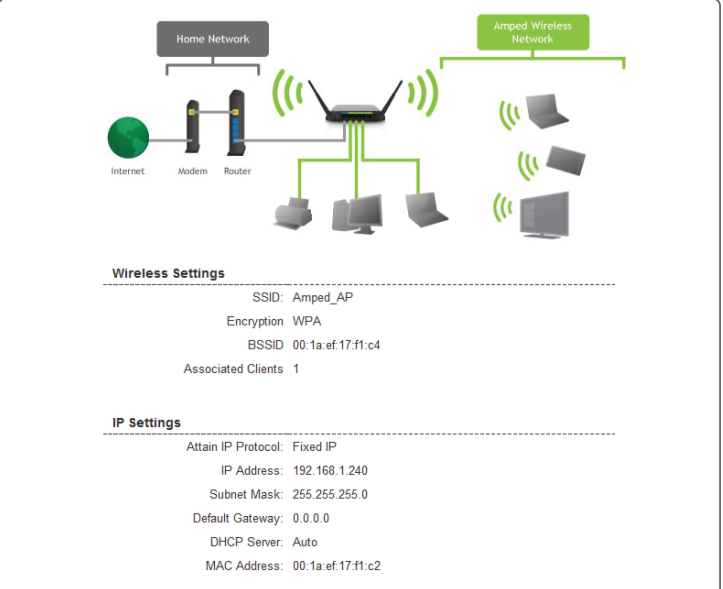

The Setup Summary provides you with information regarding your current settings.

If you have wired network devices, you may attach them to the wired ports on the back of the Smart Access Point for additional wired connectivity.

If you have any questions during the setup process please contact Amped Wireless support department:

Phone: 888-573-8820
Email: techsupport@ampedwireless.com
Web: www.ampedwireless.com/support

How to Connect your Computer Wirelessly to the Smart Access Point:

Windows 7 and Vista

A. Click on the Wireless icon to see available wireless networks (For Vista, click Start > Connect To). Select the "Amped_AP" network and click **Connect**.

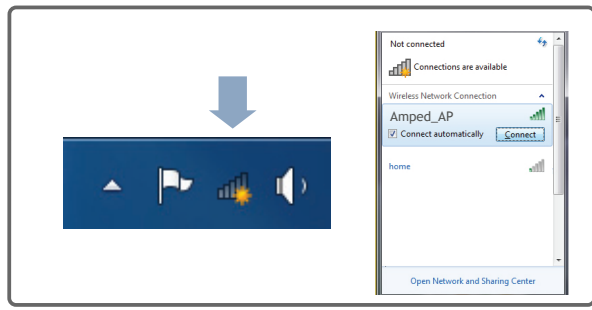

B. When prompted, enter the wireless security key "wireless" and click **OK**.

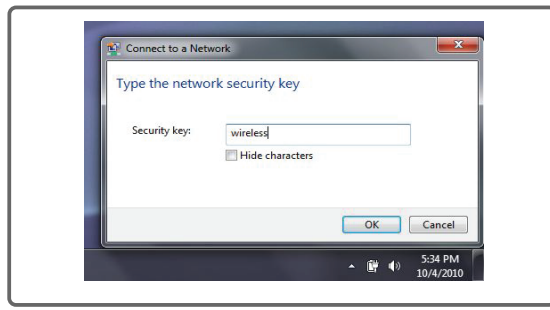

Mac OS X

A. Click on the Wireless icon to see available wireless networks. Select the "Amped_AP" network and click **Connect**.

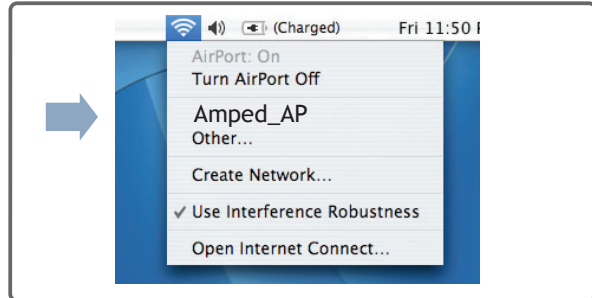

B. When prompted, enter the wireless security key "wireless" and click **OK**.



Wi-Fi Protected Setup (One Touch Setup or Push Button Configuration)

If your wireless adapter has WPS one-touch setup you can use it when connecting to the Smart Access Point. Hold down the WPS button on the Smart Access Point (back panel) for 3 seconds. The WPS LED will begin to blink. As it blinks, push the WPS button on your wireless adapter or enable WPS with the provided software for your wireless adapter.



Using the Smart Features on your Smart Access Point

The Smart Access Point is equipped with many powerful security features which can be accessed through the web menu under **More Settings > Smart Features** on the left side of the web menu:

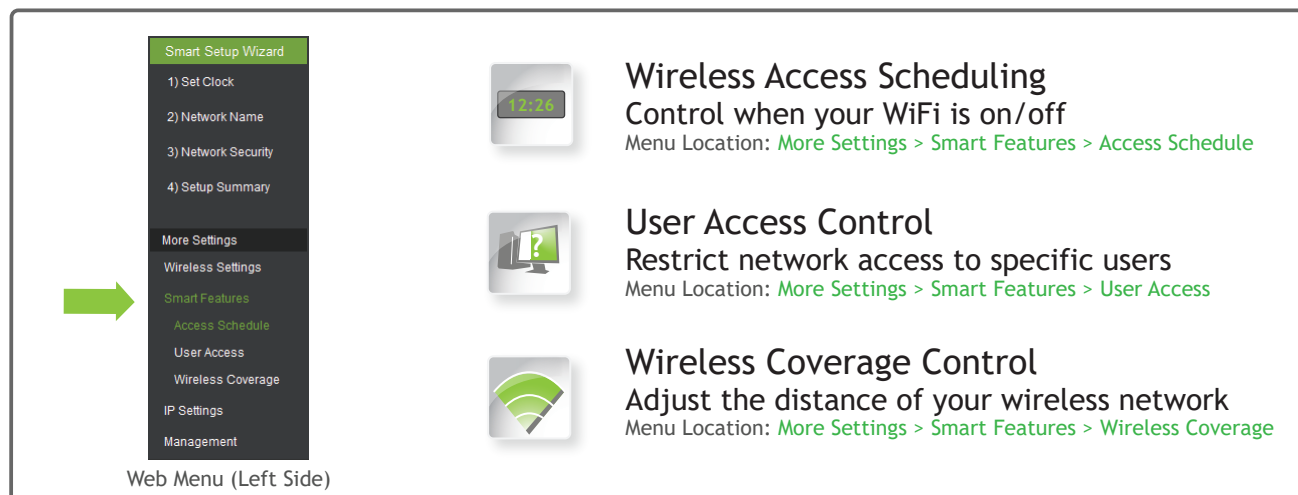

If you are unfamiliar or want more information on how to setup Smart Features, please refer to the Users Manual on the included CD.

Setting a Static / Manual IP for your Smart Access Point

If your network uses Static IP settings, you will need to set a static IP address for your Smart Access Point. To do this, access the **More Settings > IP Settings** menu from the navigation menu and select **Disabled** from the DHCP drop down menu. Next enter the IP information as it relates to your network. Click **Apply** and reboot when you are done.

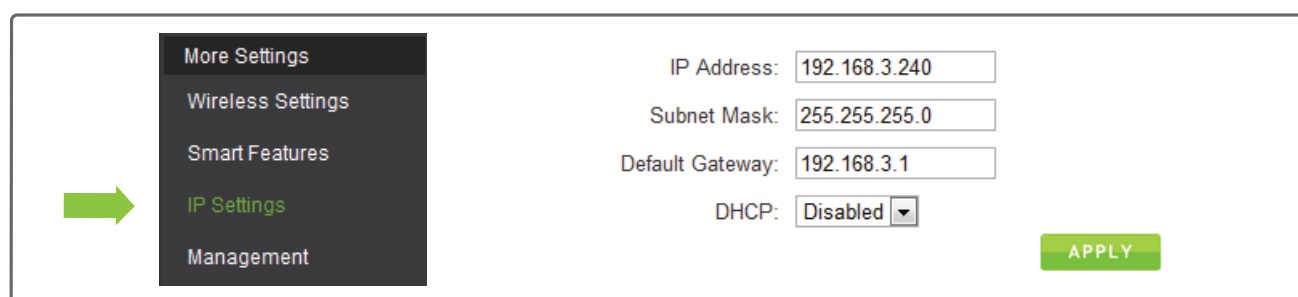

Troubleshooting Tips

Problem: I entered <http://setup.ampedwireless.com> and it failed to open the Web Menu

- Make sure your computer is connected to the Smart Access Point wirelessly and NOT using a network cable. Ensure the power is plugged in and on. Try to access the setup menu again.
- Enter the following web address into your web browser instead of 'setup.ampedwireless.com': <http://192.168.1.240>
- Power off (unplug the power adapter) the Smart Access Point and power it back on. Try again.
- Reset your Smart Access Point to default settings by holding the Reset Button (located on the back panel) for ten (10) seconds and try again.

Problem: I do not have Internet access when connecting to the Smart Access Point

- Your router or original network may not have Internet access. First check to see if you are able to access the Internet by connecting directly with your router. If you cannot, there is a problem with your router that needs to be fixed first. If you are able to access the internet, continue with the following troubleshooting options below.
- Your router may be using Static IP assignments. If so, you will need to configure a Static IP for the Smart Access Point. Connect your PC to the Smart Access Point using an Ethernet cable. Disconnect your PC from any wireless networks that it may be connected to. Access the web menu at setup.ampedwireless.com using a web browser. Access the IP settings menu from the left hand navigation bar. Select 'Disabled' under the DHCP dropdown menu and enter an IP address that matches your router's IP settings.